

SHOP FLOOR EQUIPMENT ENGINEER

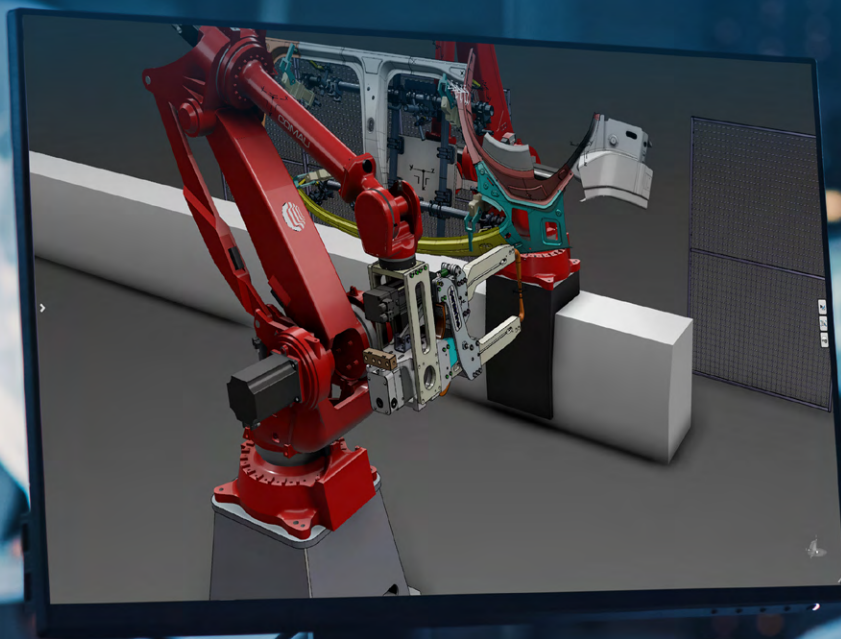

DEFINE AND VALIDATE MACHINES AND MECHANICAL EQUIPMENT IN A 3D VIRTUAL ENVIRONMENT

DELMIA Shop Floor Equipment Engineer supports production engineering at all enterprise levels. It offers a suite of powerful tools to define and validate machines and other shop floor equipment. Working on the **3DEXPERIENCE®** platform, Engineers can define machines and equipment while collaborating in real time with Product Designers, Process Planners and Machine Programmers. In the context of the Virtual Factory, Shop Floor Equipment Engineer helps to validate all mechanical equipment for a manufacturing setting, from simple clamps to complex robotic systems. The resulting efficiencies save resources and time to enhance output productivity.

BENEFITS

Discover and resolve resource-related issues at the design stage

Stakeholders from across the enterprise can collaborate on projects seamlessly and in real time within the **3DEXPERIENCE®** platform. The most current information is available to all parties, from Process Planners to Product Designers. Issues with tooling and kinematics can be discovered during the design stage and resolved before procurement. This capacity for fast, multi-disciplinary collaboration and the early resolution of issues saves time and cost throughout the enterprise.

Easily create virtual models of complex machines

Just a few clicks are needed to create a kinematic mechanism from a set of parts. User-friendly kinematics and specification management tools make it fast and easy to make modifications and assess their impact on existing or planned manufacturing environments. Once equipment models are defined and validated, the models can be saved in a catalog for reuse by multiple stakeholders. These cataloged resources minimize rework and boost productivity for future projects. This collaborative environment is ideal for multi-user environments and productive iterations.

Create a 3D Virtual Twin of your Equipment

Shop Floor Equipment Engineer provides the foundation for a Virtual Factory by enabling the creation of a complete model containing work centers, lines and factories. Generate a 3D model of each piece of equipment for re-use by layout planners, process planners, robot programmers and NC programmers.

HIGHLIGHTS

Quickly compose assemblies and position parts. Powerful tools pattern symmetrical parts and manage the assembly-level impact of functional features such as holes.

- Define complex forward kinematics for accurate motion
- Define axis-motion parameters of mechanical mechanisms
- Define home positions and joint travel limits
- Assign inverse kinematics for robots, NC machines and gantries
- Customize machine controller attributes
- Visualize and validate equipment range of motion
- Test and validate the working envelope for machines and robots
- Include cables in equipment models
- Work offline and synchronize your work upon reconnecting to the **3DEXPERIENCE** Platform

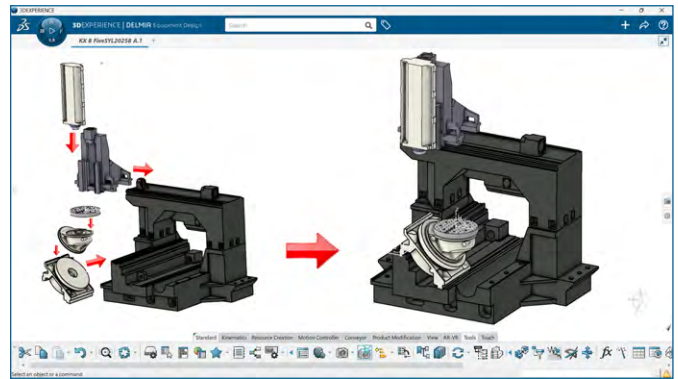

Our **3DEXPERIENCE®** platform powers our brand applications, serving 12 industries, and provides a rich portfolio of industry solution experiences.

Dassault Systèmes, the **3DEXPERIENCE** Company, is a catalyst for human progress. We provide business and people with collaborative virtual environments to imagine sustainable innovations. By creating 'virtual experience twins' of the real world with our **3DEXPERIENCE** platform and applications, our customers push the boundaries of innovation, learning and production.

Dassault Systèmes' 20,000 employees are bringing value to more than 270,000 customers of all sizes, in all industries, in more than 140 countries. For more information, visit www.3ds.com.



3DEXPERIENCE®



SIM Technologies Pvt. Ltd.

3rd Floor, "Mamanjee Centre",
S7-A, Thiru-Vi-Ka Industrial Estate,
Guindy, Chennai – 600 032

+91-8754447021

marketing@simtek.in